

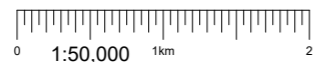

Reproduced by permission of Ordnance Survey on behalf of the Controller of Her Majesty's Stationery Office  
All rights reserved. © Crown Copyright licence no. TBC

**SITE AREA PLAN**



**SITE PHOTOGRAPH**

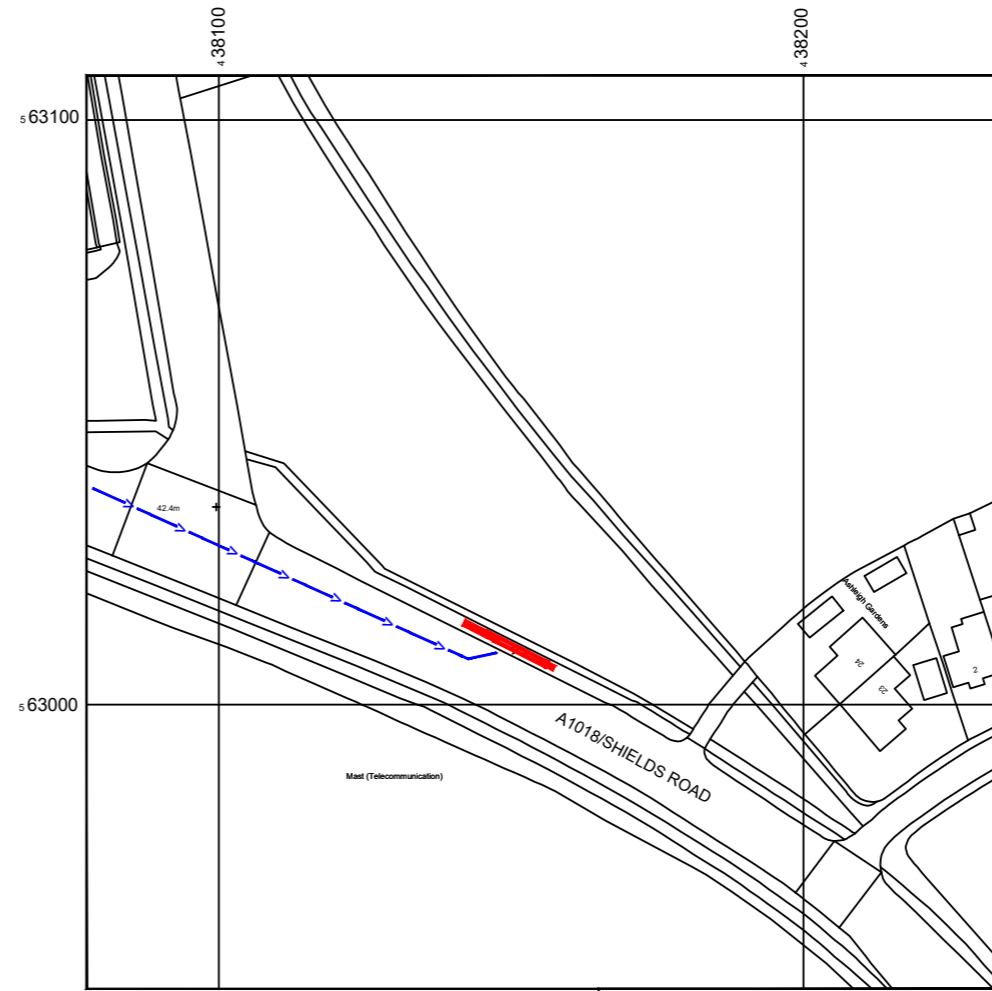

Reproduced by permission of Ordnance Survey on behalf of the Controller of Her Majesty's Stationery Office  
All rights reserved. © Crown Copyright licence no. TBC

**SITE LOCATION PLAN**



**GOOGLE MAPS QR CODE**

**GOOGLE MAPS -** [Hyperlink to map of the site](#)

**GOOGLE STREETVIEW -** [Hyperlink to streetview of the site](#)

**NOTES:**

1. ALL DIMENSIONS IN MM UNLESS OTHERWISE NOTED.

**DIRECTIONS TO SITE:**

FROM JUNCTION 3 ON A194M (WHITE MARE POOL)  
FOLLOW LEAM LN/A194 AND JOHN REID RD/A1300 TO WHITELEAS  
WAY/B1298 IN SOUTH SHIELDS. TAKE NEVINSON AVE TO SHIELDS  
RD/A1018. AT THE ROUNDABOUT, TAKE THE 2ND EXIT ONTO  
SHIELDS RD/A1018 AND SITE IS SITUATED ON THE LEFT SIDE OF  
THE ROAD.

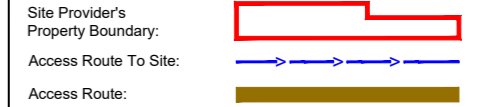

|           |                 |  |                   |                   |          |        |   |
|-----------|-----------------|--|-------------------|-------------------|----------|--------|---|
| Master:   | MBNL / EE / H3G | Project:                                 | H3G UNILATERAL SW | Purpose of Issue: | Planning | Issue: | A |
| Date:     | 22/05/2020      | Revision / Upgrade Description:          |                   |                   |          |        |   |
| Drawn:    | A. Taylor       | First Issue - Site nomination dated: TBC |                   |                   |          |        |   |
| Checked:  | A. Dobson       |  |                   |                   |          |        |   |
| Approved: | A. Dobson       |  |                   |                   |          |        |   |



Hutchison 3G UK Limited  
Star House, 20 Grenfell Road  
Mordenhead, S18 1EH  
Tel: 01628 765 000  
Fax: 01628 765 001



H3G Base Station Information line:  
0845 8043000  
Available 8am-8pm Monday to Friday

Hatfield Business Park  
Hatfield  
Hertfordshire  
AL10 9BW  
Tel: 01707 315000  
Fax: 01707 319001

**MBNL** Mobile Broadband Network Limited  
Sixth Floor, Thames Tower, Station Road, Reading, RG1 1LX

Design Consultant & Principal Contractor:



Site Name: **NEAR LAMP 1724 (P95881)**

Site ID: **769681**

Address:  
**NEAR LAMP 1724  
NORTH VERGE  
SHIELDS ROAD (A1018)  
CLEADON, SUNDERLAND  
SR6 7PX**

Title: **002 SITE LOCATION PLAN**

Project: **H3G UNILATERAL SW**

Purpose of Issue: **PLANNING**

|              |               |               |
|--------------|---------------|---------------|
| EE Cell ID:  | MBNL Cell ID: | 3UK Cell ID:  |
| <b>74020</b> | <b>STY008</b> | <b>SR0080</b> |

|  |          |
|--|----------|
| Master Drawing No:                     | Issue:   |
| <b>769681_STY008_74020_SR0080_M001</b> | <b>A</b> |

100mm  
50mm  
10mm